

KEY:

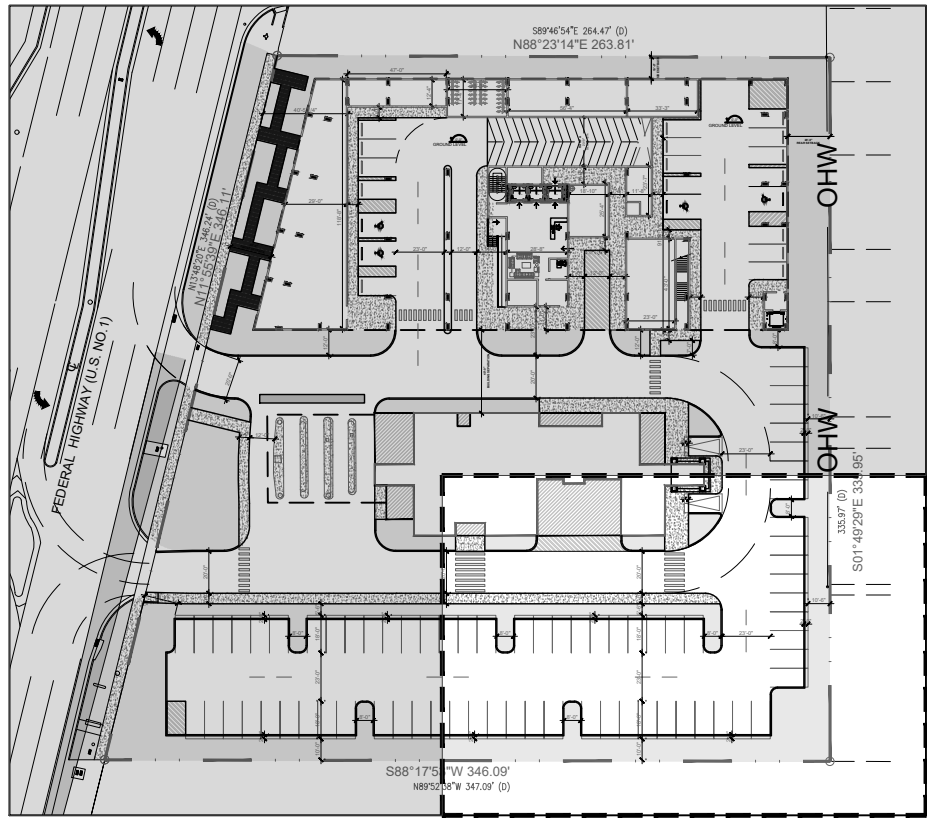

**absolute-idea.com**  
CANAL PARK  
3323 NE 163rd Street, Suite 200 North Miami Beach, FL 33160  
📞 305.792.0015 📠 305.931.0279 📧 info@absolute-idea.com

**SEAL**  
  
KEN GARDNER  
FLA 1589

Professionals

| REV. | DATE       | DESCRIPTION      |
|------|------------|------------------|
| 01   | XX-XX-2024 | D.R.C. SUBMITTAL |
|      |            |                  |
|      |            |                  |
|      |            |                  |
|      |            |                  |
|      |            |                  |
|      |            |                  |
|      |            |                  |
|      |            |                  |
|      |            |                  |

ALL MEASUREMENTS MUST BE VERIFIED BEFORE BEGINNING THE WORKS. NO MEASUREMENTS ARE TO BE SCALED DIRECTLY FROM THIS DRAWING.

Key section

**PROGRESS SET**

Client

**VERA FUND**  
NICK POLYUSHKIN  
& YURI KHARITONENKOV  
TEL: 305.833.3303

Project

**1600 S FEDERAL HIGHWAY  
(MIXED-USE PROJECT)**

1600 SOUTH FEDERAL HIGHWAY,  
POMPANO BEACH, FL 33062

| Title                        |          |  |  |
|------------------------------|----------|--|--|
| PLANTING PLAN - GROUND FLOOR |          |  |  |
| Drawn                        | Field    |  |  |
| Verified                     | Scale    |  |  |
| Approved                     | Date     |  |  |
| Project Manager              | Dwg. no. |  |  |
| Project                      |          |  |  |

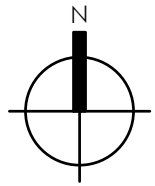

PLANTING PLAN - GROUND FLOOR

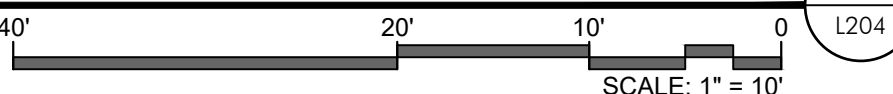

DRC

PZ24-12000027

04/16/2025